

Finish 405 Now

Todd Woosley, ETA Boardmember, Transportation
Commissioner

Bellevue Downtown Association

10/16/2018

Remaining I-405 Master Plan Improvements

Complete mainline capacity improvements

- 5 lanes in each direction
- Interchange modifications

Direct connector ramps

- Freeway to freeway connections

Direct access ramps

- Freeway to arterial connections



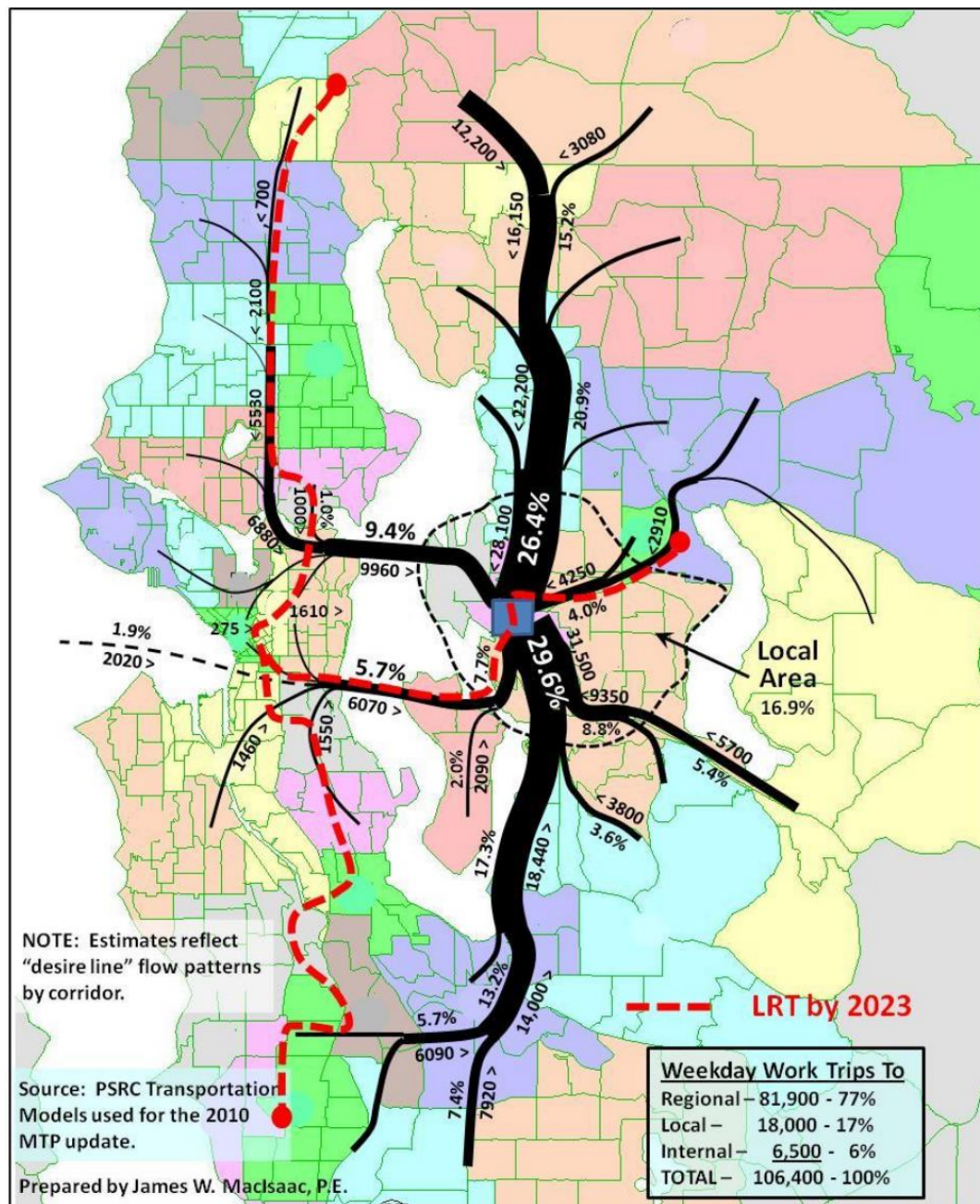

2040 Home-Work Person Trips To DOWNTOWN BELLEVUE

Bellevue Downtown Trip Growth

Daily Person Trips 2010 & 2030

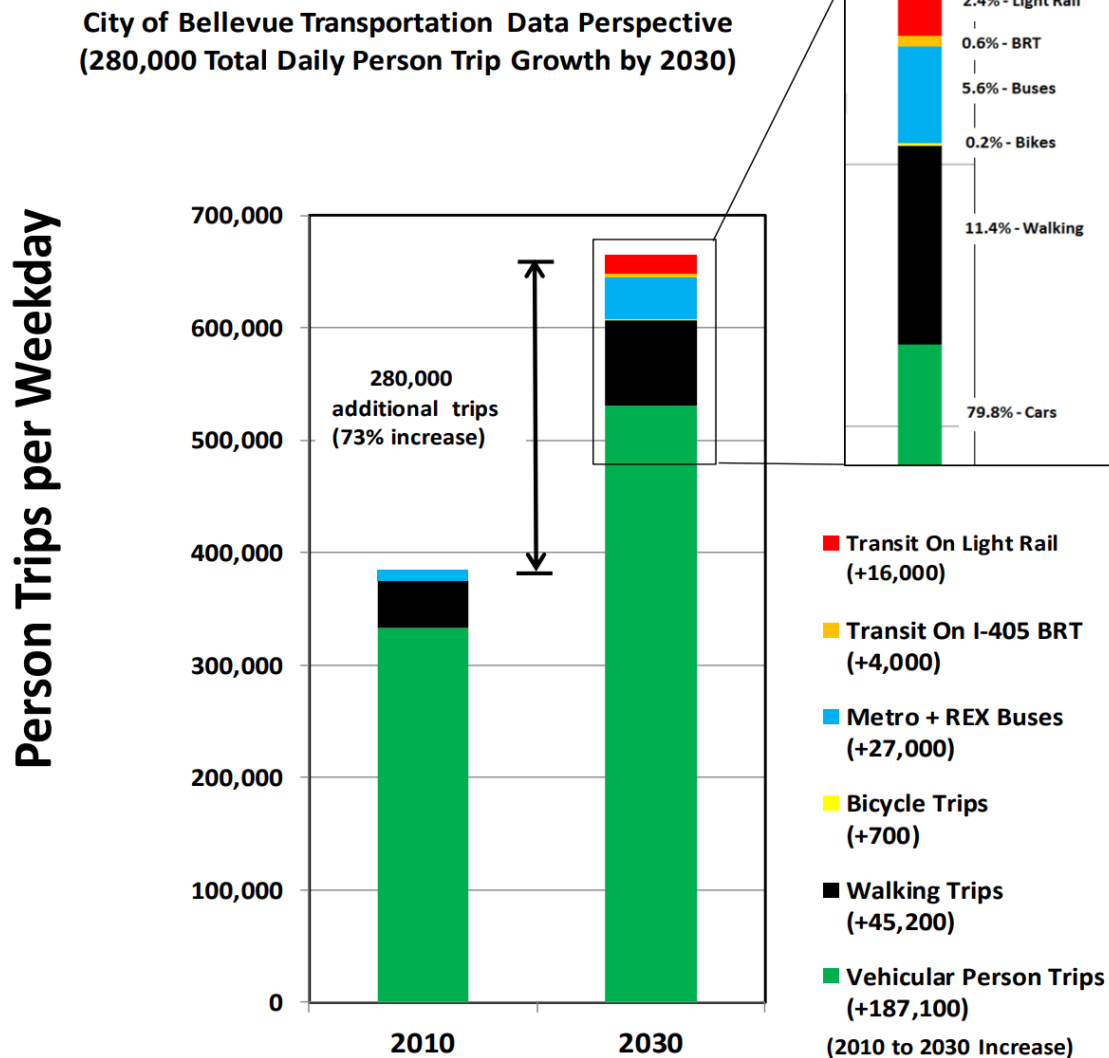

Source: City of Bellevue Downtown Transportation Plan Update, Puget Sound Regional Council (PSRC) 2014 Update of Transportation 2040, Sound Transit East Link FEIS for Light Rail and ST 3 Draft Plan for I-405 BRT

Potential Bellevue Master Plan improvements



- **Direct connector ramps**
 - SR 520 HOV to I-405 express toll lanes
 - I-90 HOV to I-405 express toll lanes
- **New general purpose ramps**
 - Braided ramps from westbound SR 520 to southbound I-405 and southbound I-405 to NE 10th Street
 - On-ramp from 116th Avenue NE/Lake Hills Connector to southbound I-405
 - SR 520/124th Ave NE interchange completion
- **Northeast Sixth Street extension**
- **Options for new ramps/interchange configurations at NE Second Street/Main Street**

Potential options for new interchanges near downtown Bellevue

NE 2nd Street ramps



- NE 2nd Street on-ramp to southbound I-405
- Northbound I-405 flyover off-ramp to NE 2nd Street

NE 2nd Street ramps/
extension



- NE 2nd Street extension
- NE 2nd Street on-ramp to southbound I-405
- Northbound I-405 off-ramp to NE 2nd Street

Main Street ramps

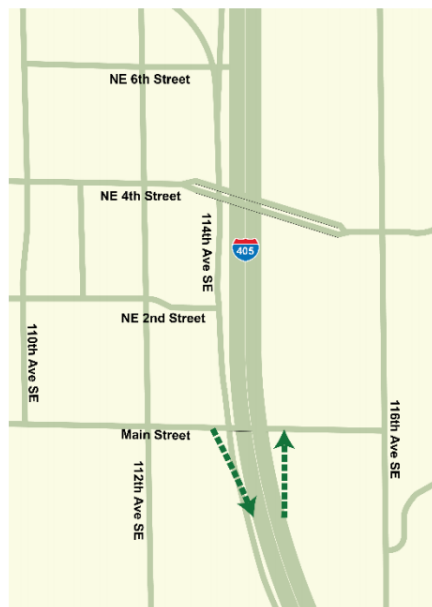

- Main Street on-ramp to southbound I-405
- Northbound I-405 off-ramp to Main Street

NE 2nd Street Ext./
Lake Hills Conn. on-ramp

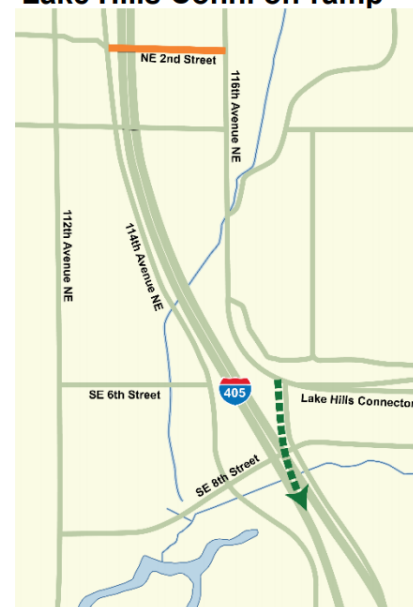

- NE 2nd Street extension
- Lake Hills Connector on-ramp to southbound I-405

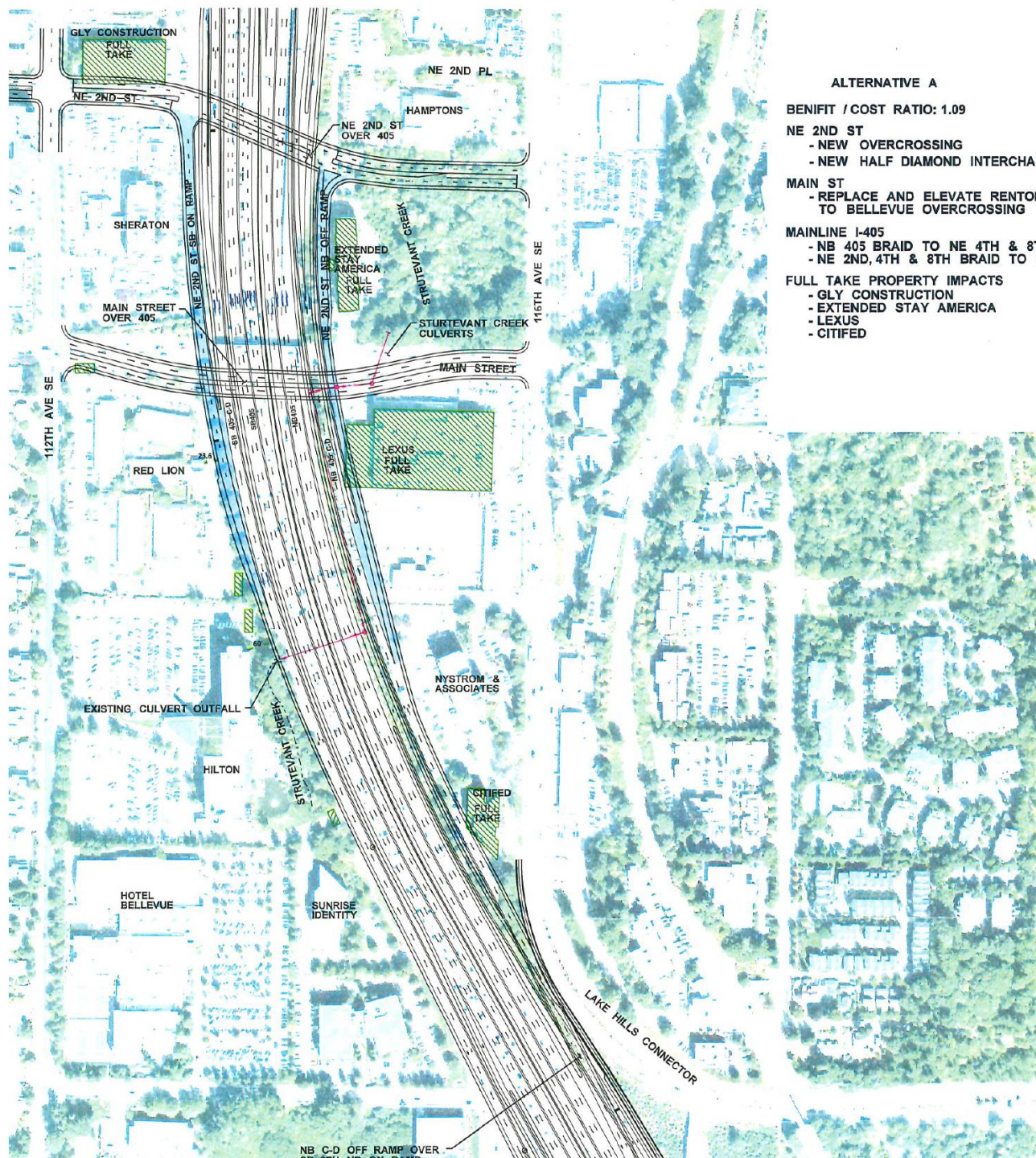

ALTERNATIVE A

BENIFIT /COST RATIO: 1.09

NE 2ND ST

- NEW OVERCROSSING
- NEW HALF DIAMOND INTERCHANGE

MAIN ST

- REPLACE AND ELEVATE RENTON TO BELLEVUE OVERCROSSING

MAINLINE I-405

- NB 405 BRAID TO NE 4TH & 8TH
- NE 2ND, 4TH & 8TH BRAID TO SB 405

FULL TAKE PROPERTY IMPACTS

- GLY CONSTRUCTION
- EXTENDED STAY AMERICA
- LEXUS
- CITIFED

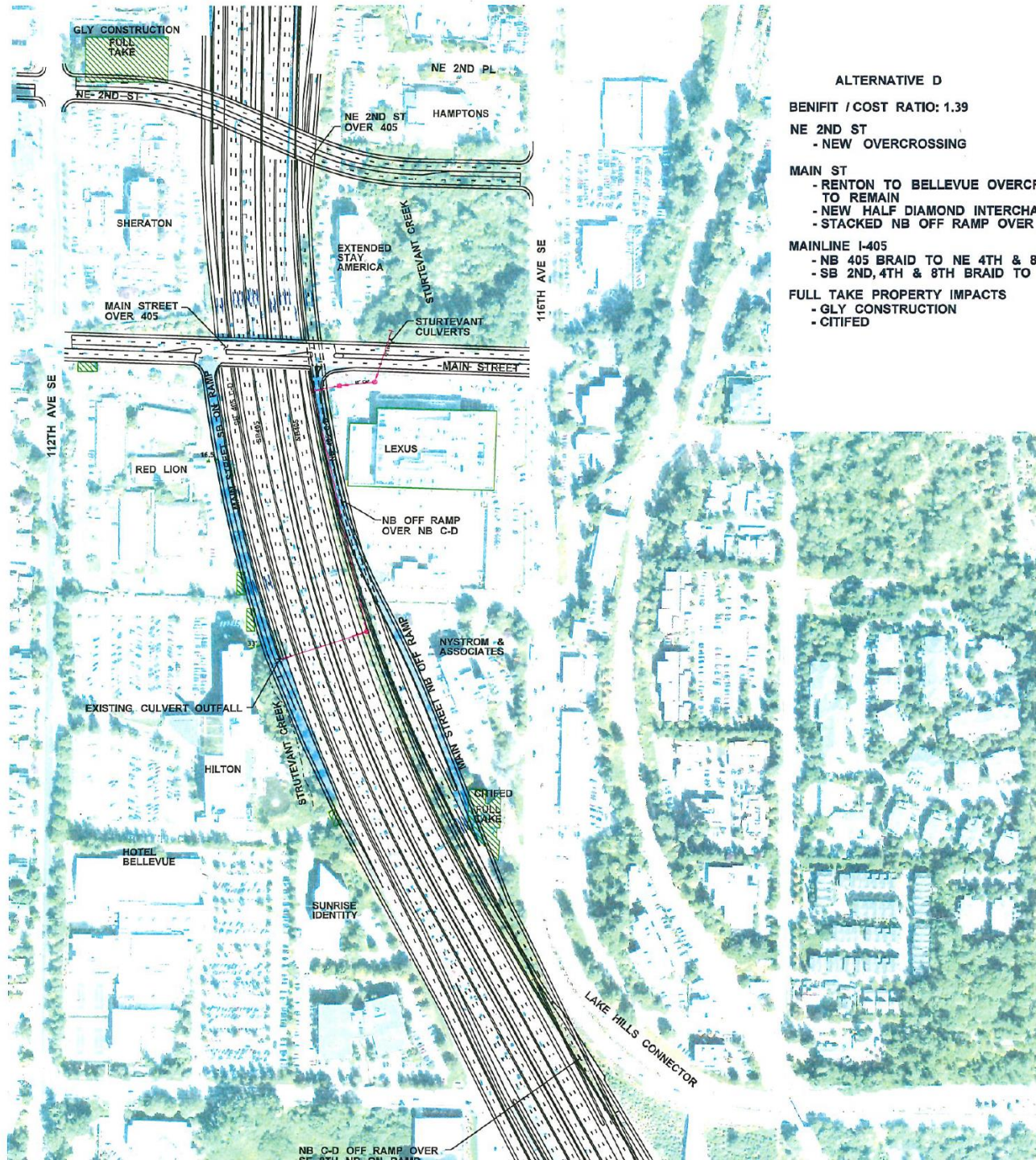

ALTERNATIVE D

BENIFIT / COST RATIO: 1.39

NE 2ND ST
- NEW OVERCROSSING

MAIN ST
- RENTON TO BELLEVUE OVERCROSSING
TO REMAIN
- NEW HALF DIAMOND INTERCHANGE
- STACKED NB OFF RAMP OVER NB C-D

MAINLINE I-405
- NB 405 BRAID TO NE 4TH & 8TH
- SB 2ND, 4TH & 8TH BRAID TO SB 405

FULL TAKE PROPERTY IMPACTS
- GLY CONSTRUCTION
- CITIFED

BELLEVUE

SUNRISE
IDENTITY

LAKE HILLS CONNECTOR

405 OVER
SE 8TH ST

SE 8TH ST

GREENBAUM

FULL
TAKE

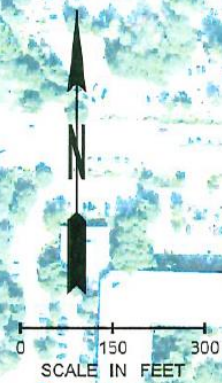

City Council Vision Priorities

2018-2020

- Continue to execute our transportation capital plans for future growth and mobility of the city. Use the funding provided by the Neighborhood Safety Connectivity and Congestion Levy to improve the safety, transportation and quality of life in neighborhoods.
- Advocate with the state Department of Transportation and regional agencies for acceleration of the I-405 Corridor Program, completion of SR 520, including Bellevue projects (i.e. NE 6th, 124th NE Interchange, braided ramps, Coal Creek Parkway).
- Continue to fund, design and build projects within the Downtown Transportation Plan, Wilburton Connection and BelRed.
- Continue the oversight of light rail construction and ensure that we implement an effective strategy for construction mitigation for neighborhoods, traffic and business.